

VOLTS	AC 100-240V /277V   50 /60HZ
PROTECTION CLASS	Class I
POWER FACTOR	>0.95
OPERATING TEMP.	-40°C ~ +50°C
LED	SMD 3030
LAMP COVER MATERIAL	Light Diffusion Anti-UV PC
Base Material	Aluminum Alloy
IP RATING	IP65
IK RATING	IK08
SPD	10KV
Lifespan L70 at 25 °C	>100,000 h

## CAUTION

- Installation and maintenance must be performed by professionals only.
- Please ensure the pole is strong enough and the screws are tightened.
- The ground wire must be securely connected.
- Please make sure the lamp is working with correct input voltage.
- Cut off the power before maintenance.
- Do not use chemicals or corrosive cleaner to clean the fixture.
- If the external flexible cable or cord of this luminaire is damaged, it shall be exclusively replaced by qualified person in order to avoid a hazard.

Fixture Length (mm)	Nominal Wattage (W)	Fixture Size (mm)	Fixture Weight (kg)	Packing Type (units /ctn)
600	20	Φ114 x600	2.65	1
1000	30	Φ114 x1000	3.5	1
2000	40	Φ114 x2000	6.0	1/2
3000	50	Φ114 x3000	8.8	1/2

## Fixture Length > 1000mm or Fixture Length ≤ 1000mm(RGB DMX 512 Version)

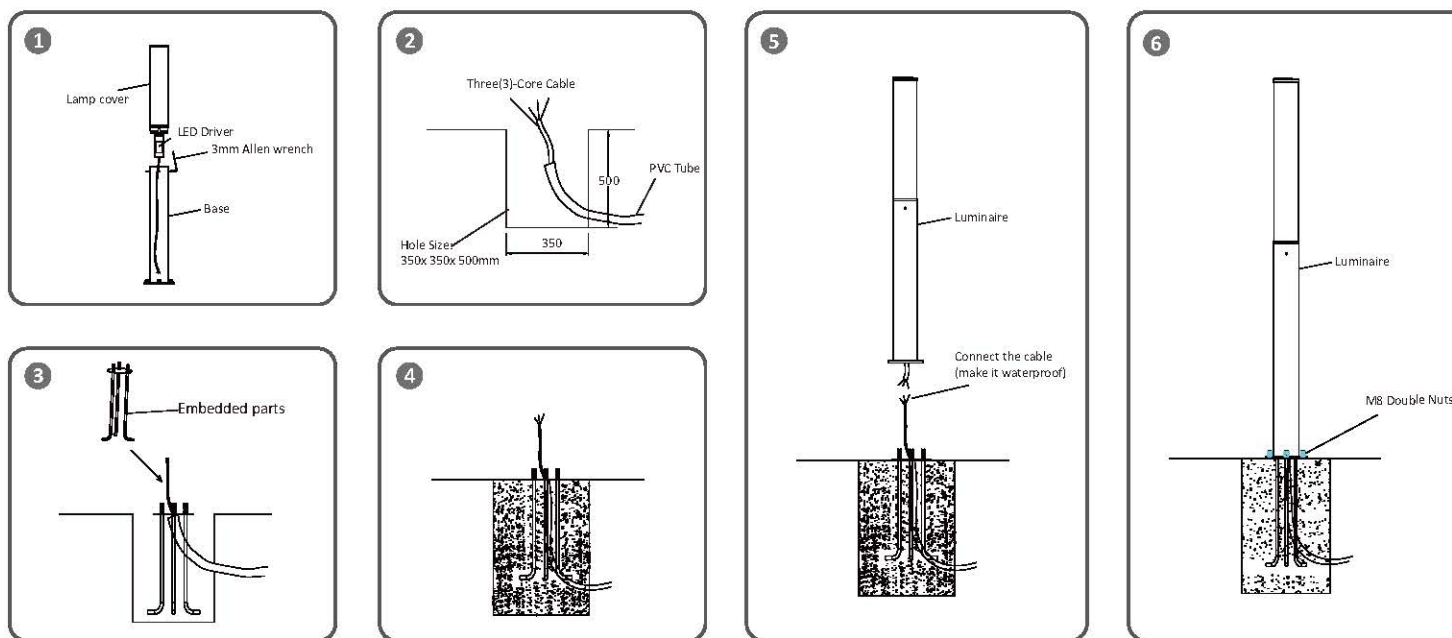

- STEP 1:** Use a 3mm Allen wrench to fix the lamp cover and base together. See figure ①
- STEP 2:** Dig a hole to bury a PVC tube, then lead out a three-core cable. See figure ②
- STEP 3:** Put the embedded parts into the 350\*350\*500 hole, pour cement to complete the pouring like figure ③ ④
- STEP 4:** Finish the cable connection according to "FIXTURE WIRING" diagram and test the light. See figure ⑤
- STEP 5:** Fix the luminaire part to the embedded parts by 6pcs M8 Nuts. See figure ⑥

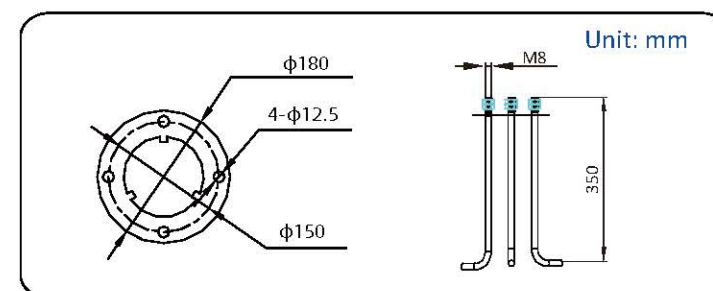

Fixture Length ≤ 1000mm (White Color Version or RGB Version)

### Select embedded parts

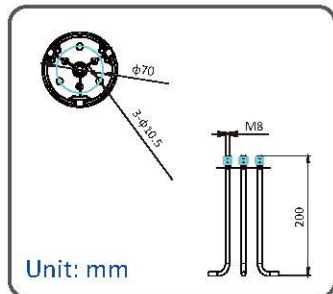
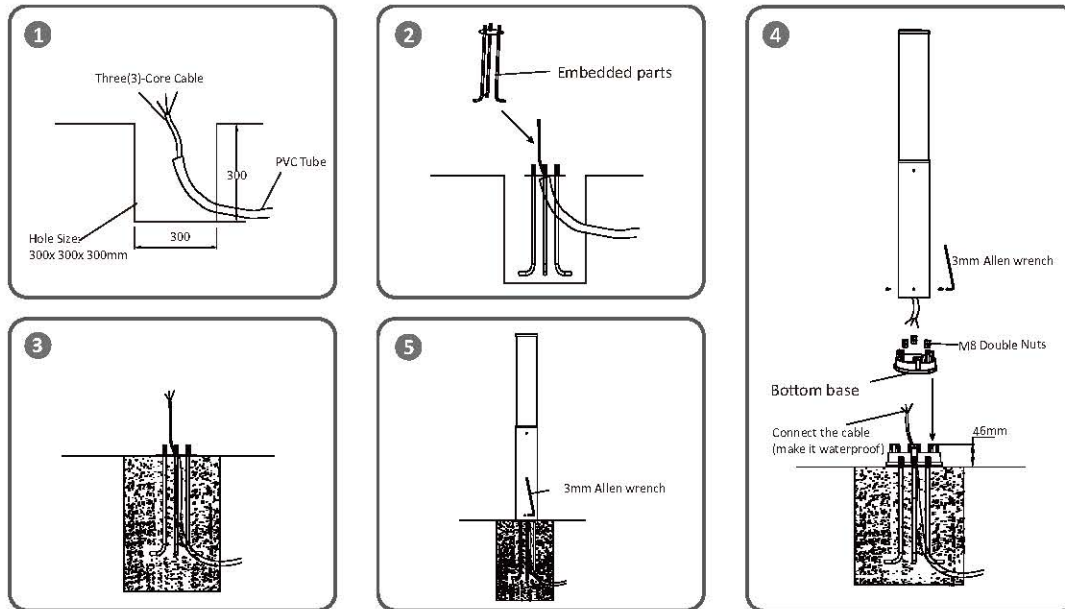

- STEP 1:** Dig a hole to bury a PVC tube, then lead out a three-core cable. See figure 1
- STEP 2:** Put the embedded parts into the 300\*300\*300 hole, pour cement to complete the pouring like figure 2 3
- STEP 3:** Use a 3mm Allen wrench to unscrew the screws on bottom base, pass the cables through the bottom base and fix it to the embedded parts with 6pcs M8 Nuts, finish the cable connection according to "FIXTURE WIRING" diagram and test the light, See figure 4
- STEP 4:** Fix the luminaire with bottom base by 3mm Allen wrench. See figure 5

FIXTURE WIRING  
Class I BASED

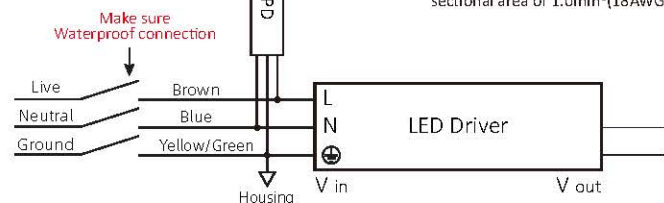

Input cable should be at least H05RN-F 3x1.0mm<sup>2</sup>(SJT/W 18AWG) or outdoor grade cable with rubber sheathed(not supplied). The cable must have a minimum cross sectional area of 1.0mm<sup>2</sup>(18AWG).

\*If the fixture with built-in dimming function, please connect INPUT POSITIVE(+) signal conductor to DIM+ (PURPLE WIRE), INPUT NEGATIVE(-) signal conductor to DIM-(GREY WIRE) of LED driver.

### Select expansion screw

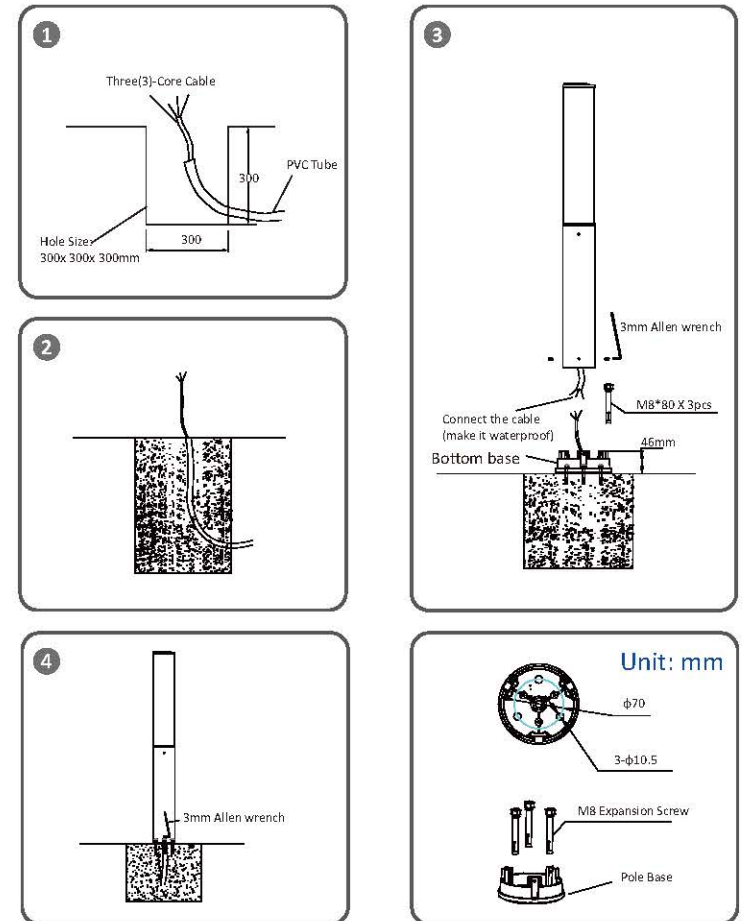

- STEP 1:** Dig a hole to bury a PVC tube, then lead out a three-core cable. See figure 1
- STEP 2:** Pour cement like figure 2, If the ground is already a cement ground, no need to pour it again.
- STEP 3:** Use a 3mm Allen wrench to unscrew the screws on bottom base, pass the cables through the bottom base and fix it to the 3 units M8 expansion screw driven into the ground in advance, finish the cable connection according to "FIXTURE WIRING" diagram and test the light. See figure 3
- STEP 4:** Fix the luminaire with bottom base by 3mm Allen wrench. See figure 4

Unit: mm

